

PROJECT NAME:	DATE:	TYPE:
SPECIFIER:	PREPARED BY:	
PART NO.:		



PROFILE CHANNEL SERIES

TBD.E25P

RECESSED FLANGELESS-EDGED CHANNEL



Mud-in trimmed for a flangeless-edged finish. Suitable for recessed applications in plaster ceilings or walls. The durable Anodized Aluminum Profile Channel not only adds a great finished appearance to your space, but also protects LED chips from dust, and provides superior thermal management for higher wattage LED strips, prolonging the overall lifetime of the lighting system. Patented diffusers maximize lumen output and beam distribution.

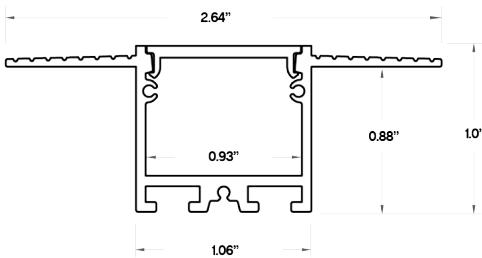

FEATURES

- Recessed Mount to Fit Flush on Installation Surface
- Frosted Lens Diffuser Included
- Matte White Powder Coat Finish
- 48", 96"
- Field Cuttable
- Custom Lengths Available
- Optional Accessories Sold Separately



OPTIONAL ACCESSORIES

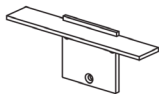

End Cap
TBD.E25P-EC
(Sold Separately)

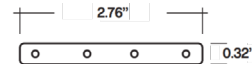
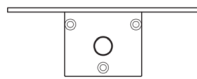

Straight Connector
TBD.E25P-SC
(Sold Separately)

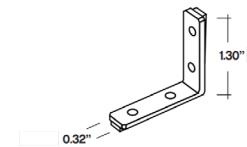

Internal Connector
TBD.E25P-IC
(Sold Separately)

ORDERING GUIDE

TBD.E25P

SIZE
48 - 48"
96 - 96"

LENS
F - Frosted Lens