

PROJECT NAME:		TYPE:
DATE:		
SPECIFIER:		
PART NO.:	PREPARED BY:	



3 LED FESTOON LAMPS

GENERAL PURPOSE USE LED LIGHT SOURCE

The LED Festoon lamp product can be used for numerous amounts of installations. This light is light weight and can be installed in various locations with ease. The product is durable, long lasting, and cool to the touch. Fits with all standard festoon sockets.

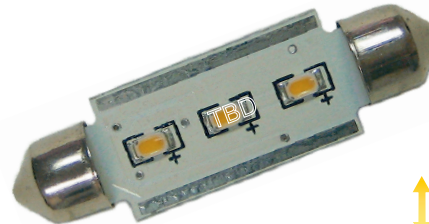

↑ DIMMABLE ↓

FEATURES AND BENEFITS

- Solid state lighting device, works well in all types of environments
- Instant on, no warm up time required
- Lasts 10 times longer than incandescent
- No mercury, No lead
- No IR, No UV
- Lumen Maintenance: L80 (80% @ 50,000 hrs)
- Fits standard festoon socket (1 7/8")
- Cool, Neutral, and Warm White Colors
- 12VAC/DC operation
- Dimmable, with Low Voltage Magnetic Dimmer

Optional Features:

- Water resistant aluminum housing
- Looped or cartridge style end cap

DIMENSIONS

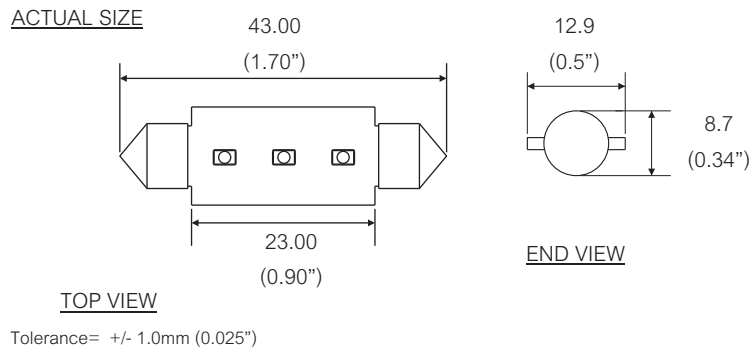

COLORS



*US7,307,391, International Patents Pending



PROJECT NAME:	TYPE:
DATE:	
SPECIFIER:	
PART NO.:	PREPARED BY:



3 LED FESTOON LAMPS

GENERAL PURPOSE USE LED LIGHT SOURCE

OPTIONAL DIMENSIONS

ACTUAL SIZE

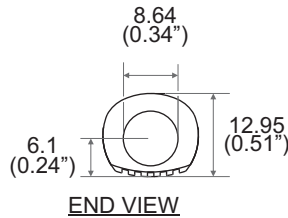
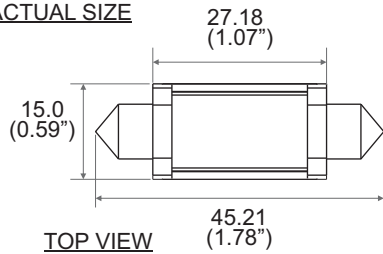

Tolerance= +/- 1.0mm (0.02")

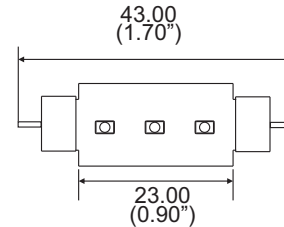

TOP VIEW

NOTE: For cartridge style looped end, the cartridge can be fitted over the LED festoon end cap.

OPTIONAL WATER RESISTANT TYPE



OPTIONAL:
LOOPED END
(CARTRIDGE STYLE)



SPECIFICATIONS

Product Part Number	Electrical Specification						Optical Specification				
	Input Voltage (V)			Input Current (mA)	Voltage Type	Power Consumption	Intensity (Estimate)	Viewing angle	Color Temperature (Kelvin)		
	MIN	to	MAX	TYP	AC/DC	(Watt)	(Lumens)	(Degree)	MIN	TYP	MAX
TBD.3C-502	9Vac	to	14Vac	35	12Vac	0.42	42	120	4745	5000	5310
	9Vdc	to	14Vdc	37	12Vdc	0.44	45				
TBD.3C-352	9Vac	to	14Vac	35	12Vac	0.42	39		3200	3500	3710
	9Vdc	to	14Vdc	37	12Vdc	0.44	41				
TBD.3C-282	9Vac	to	14Vac	35	12Vac	0.42	35		2580	2700	2800
	9Vdc	to	14Vdc	37	12Vdc	0.44	37				

Operating Temperature : -30°C(-22°F) to 50°C (122°F)

ORDERING GUIDE

Examples:

TBD-3C-504 = TBD LED Festoon, Cool White, 24V

TBD-3C-284-E = TBD LED Festoon, Warm White, 24V, With Housing



SERIES
Half Watt
Dimmable
LED Series

OF LEDs
3 LED

LED VERSION
"C" Type

COLOR
28 = Warm White (2800K)
35 = Neutral White (3500K)
41 = Mid-White (4100K)*
50 = Cool White (5000K)

VOLTAGE
12V AC/DC

OPTIONS
E = With Housing*
L = Looped End Style*

*Special Order, contact TLS for further details.

